

www.boy-a-mic.com



BOYA AUDIO EQUIPMENT (SHENZHEN) CO., LIMITED

Add: A16 building, New Material Industrial Park of Silicon Valley Power, Guanlan Town, Shenzhen, China

Tel: (86)0755-28435910

Email: sales@boy-a-mic.com

博雅音频器材(深圳)有限公司

地址: 中国深圳市观澜镇硅谷动力新材料工业园区A16栋

电话: (86) 0755 - 28435910

电子邮件: sales@boy-a-mic.com

# BY-WM5

Wireless microphone

无线麦克风

Instruction Manual

使用说明书

## Instruction Manual

The BOYA BY-WM5 Wireless microphone is Compact, high performance, lightweight and compatible with DSLR cameras, Camcorders, Audio recorder etc.

It consists of a transmitter, receiver, two piece of earphone(one is with speaker), an audio signal cable, a lavalier/lapel microphone.

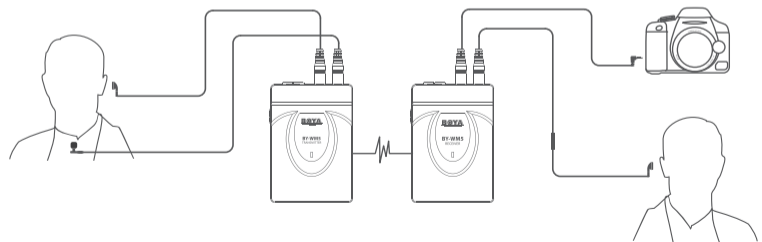
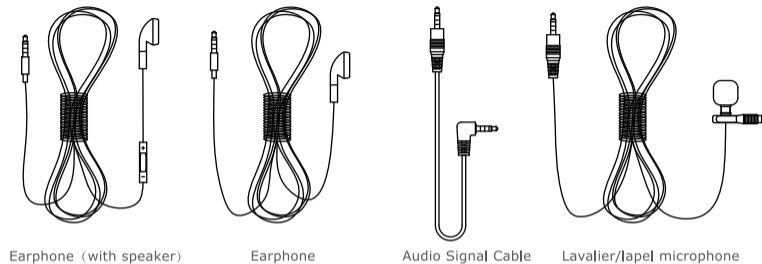
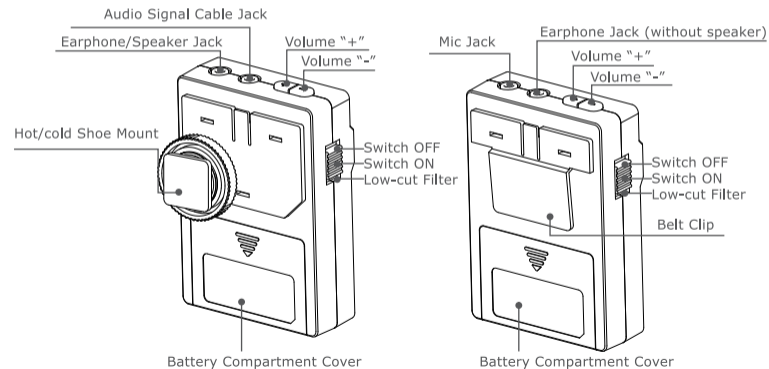

## How to use it

### Insert batteries in the transmitter and receiver units

1. Both transmitter and receiver requires two LR03/AAA size batteries.
2. Slide and remove the transmitter's battery compartment cover.
3. Insert two batteries.
4. Close the battery compartment cover.
5. Do the same ways as step 2 to 4 to insert battery into receiver.



### Precautionary measures when using batteries

Batteries/power packs, if inappropriately handled, can run out or explode. Please observe the following notes on safety when handling batteries to be used in this device:

- Use only batteries mentioned in these operating instructions.
- Do not lay the batteries in a fire and do not expose them to direct heat.
- In order to avoid damage to the product you must make sure that you remove the batteries, if you do not use the product over a longer period of time or if the batteries have been discharged.
- If battery fluid comes into contact with skin or clothes, rinse it off immediately with fresh water.



- Please read these instructions for use thoroughly before you use this new equipment for the first time. It contains everything you need to know in order to avoid damage to persons or property.
- Strictly follow all notes on safety in these instructions for use.
- Keep these instructions for use in a safe place. If you sell your equipment or pass it on to someone else, you should also pass on these instructions for use.

## Connecting the transmitter and receiver

### Receiver

1. Mount receiver to camera.
2. Insert the straight plug of the connecting cable into the receiver "LINE OUT" jack.
3. Insert the other plug of the connecting cable into camera "MIC" socket.
4. Insert earphone (the one with speaker) into receiver "🎧".
5. Slide the power ON/OFF switch to ON position (the LED indicator will light in green)

### Transmitter

1. Insert the earphone (the one without speaker) into transmitter "🎧".
2. Insert the lavalier/lapel microphone into transmitter "🎤".
3. Slide the power ON/OFF switch to ON position (the LED indicator will light in green).
4. The belt clip on the back of the unit clips the transmitter onto a belt, or the transmitter simply can be put into a pocket.

If transmitter and receiver connect, the light will flash every 2.5 seconds. Otherwise, the light will flash rapidly.

Before leaving factory, the connection of both of transmitter and receiver will be established.

#### How to connect transmitter and receiver

1. Turn on the receiver
2. Press the button VOLUME "+" and "-" for 3 seconds at the same time.
3. Repeat steps 1 to 2 steps to set up the transmitter.

#### Status of the communication indicator

Status	Receiver	Transmitter
Unit is turned ON	Flashing	
Wireless communication is established	Flashing continually every 2.5 seconds	
Receiver unit is turned OFF(Transmitter is still ON)	Off	Flashing
Transmitter unit is turned OFF(Receiver is still ON)	Flashing	Off
Low power	Flashing in red	

#### Specifications:

- RF Modulation: GFSK (Gauss frequency Shift Keying)
- Frequency band: 2.4GHz (2405-2478MHz)
- Frequency response: 35Hz-14KHz±3dB
- Signal/Noise: 76dB or more
- Distortion: 0.1% or less (32Ω,1 KHz,65mW output)
- RF output level:5 mW
- Earphone output level: 32Ω,65mW
- Reception sensitivity: -85dB +/- 3dB / 0dB=1V/Pa, 1kHz
- Audio input connector: 3.5mm mini jack
- Operation range: 50m (164ft.)
- Power requirements: 3.0V DC (Two LR03/AAA size batteries)
- Consumption power:Transmitter: 3.3V/110 mA  
Receiver: 3.3V/100 mA
- Battery life:Transmitter: Approx. 3.5 hours  
Receiver: Approx. 4 hours
- Dimensions:Transmitter: 60mm x 86mm x28mm (W/H/D) (2.36 x 3.3 x 1.1 inches)  
Receiver: 60mm x 86mm x41mm (W/H/D) (2.36 x 3.3 x 1.61 inches)
- Weight:Transmitter: 136g (4.37oz) (Without battery)  
Receiver: 152g (4.89oz) (Without battery)

## **CAUTION**

1. Please use our original Audio Signal Cable which is equipped, it's more compatible with the wireless microphone, and make the sound better.
2. The figure given is only the approximate value that applies when there are no obstructions between the transmitter and receiver. This distance will vary depending on metal objects, people and other obstructions and on the signal strength.
3. Battery life may vary depending on the type of battery used.

## **IMPORTANT**

- If you do not intend to use the wireless microphone for a long period time, please remove the batteries from both the transmitter and receiver.
- Do not touch the lavalier/lapel microphone, transmitter and receiver while recording, as this will cause noise to be recorded.
- Do not let the transmitter close to high-voltage equipment or to devices that emit strong electromagnetic fields, otherwise, it may cause the noise to be recorded.
- Do not use or leave the transmitter and receiver in hot, humid places.
- Do not leave the receiver attached to the camera when storing the camera in a case.
- Do not mix up to use the transmitter and receiver.

## **MAINTENANCE**

- Do not operate the device with wet hands or feet.
- Clean the equipment only in the way described in the instructions for use.

- Take care to prevent the equipment from dropping down. Make sure that the device is properly fastened and reliably mounted. If the device has dropped down on the floor have it inspected by a skilled electrician before you switch it on again.
- Should the equipment be damaged or defective, or if you notice a scorching smell: Interrupt the electric power supply immediately by removing the batteries. Do not operate the device with a damaged housing, do not repair the device yourself. Have the device only repaired by a skilled electrician.
- Always keep your device in good condition, as specified in these instructions for use.
- Do not open the device.

## **WARNING**

- Keep the wireless microphone out of the reach of children.
- Never use leaking batteries and never expose batteries to excessive heat or fire.

# 操作说明

博雅BY-WM5 无线麦克风是一款轻巧，高性能的麦克风，它适用于单反相机，家用DV，摄录机，以及专业录音机等等。

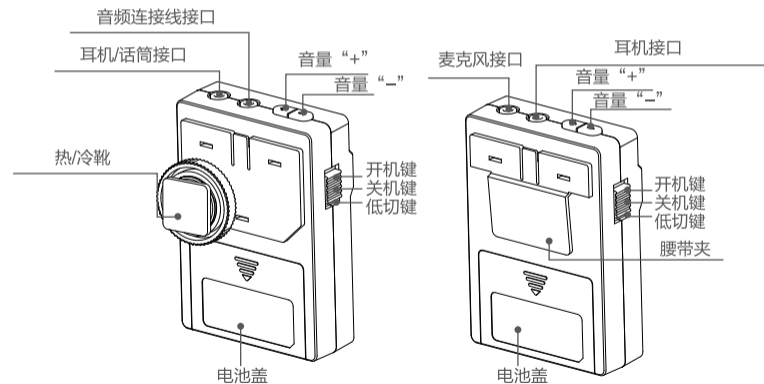

这款产品包含配件如下:

接收器:1个  
发射器:1个

耳机:2个 (其中一个带话筒, 用于接收器上面)  
音频连接线:2条  
领夹式麦克风:1个

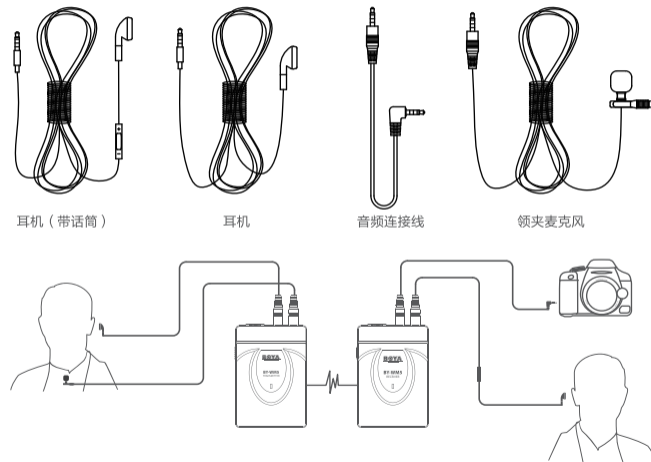

# 如何使用

## 如何装上接收器和发射器电池



1. 电池要求：2个AAA/7号 电池
2. 打开发射器电池仓后盖
3. 插入2个电池
4. 关上发射器电池仓后盖
5. 装接收器电池时，重复以上2到4步。

## 如何连接接收器和发射器

### 接受器

1. 将接收器安装到相机上面。
2. 将音频连接线直的那头插入接收器“LINE OUT”接口。
3. 将音频连接线的另外一头插入相机“MIC”接口。
4. 将耳机（带有话筒）连接到接收器的“ ”接口。
5. 打开电源（电源指示灯会变绿，快闪）。

### 发射器

1. 将耳机（不带话筒）插入接收器“ ”接口。
2. 将领夹麦克风插入接收器“ ”接口。
3. 打开电源（电源指示灯会变绿）。
4. 将接收器夹在腰带上，或者放在口袋。

如果发射器和接收器的信号已经连接上，电源指示灯将每隔2.5秒闪一次。若是没有连接上，电源指示灯显示快闪。

出厂前，每个产品的发射器和接收器都已配对设置。

## 如何设置发射器和接收器：

1. 打开接收器。
2. 同时按下音量“+”和音量“-”键3秒。
3. 设置发射器时，重复1和2步。

## 电源指示灯会有以下情况：

指示灯状态	接收器	发射器
打开发射器和接收器	快闪	
发射器和接收器信号已经连接	每隔2.5秒闪一次	
接收器关闭(发射器打开)	关闭	快闪
发射器关闭(接收器打开)	快闪	关闭
电量低	红灯	

## 规格:

- 调制模式: GFSK (高斯频移键控)
- 频率范围: 2.4GHz (2405-2478MHz)
- 频率响应: 35Hz-14KHz  $\pm$  3dB
- 信噪比: 76dB以上
- 失真比: 0.1% 以下 (32欧姆,1kHz,65毫瓦输出)
- 射频输出电平: 5毫瓦
- 耳机输出电平: 32欧姆,65毫瓦
- 接收灵敏度: -85dB +/- 3dB / 0dB=1V/Pa, 1kHz
- 音频输入接口: 3.5毫米接口
- 通讯距离: 50米
- 电源要求: 3.0伏 DC (2个AAA/7号 电池)
- 消耗功率: 发射器: 3.3伏/110 毫安  
接收器: 3.3伏/100毫安
- 电池使用寿命: 发射器: 约3.5 小时  
接收器: 约4小时
- 尺寸: 发射器: 60毫米 x 86毫米x28毫米  
接收器:60毫米x 86毫米x41毫米
- 重量: 发射器:136克 (不含电池)  
接收器:152克 (不含电池)

## 注意

- 1.请使用原厂配的音频连接线, 因为此线有做特殊处理, 会使音质达到更好。
- 2.当发射器和接收器之间没有障碍物时, 给出的数字只是大概的通讯距离。取决于金属物体, 人体等障碍物和信号强度, 距离会发生变化。
- 3.电池的寿命很大程度取决于电池使用的类型。

## 重要

- 如果你打算长时间不用麦克风, 请将电池取下。
- 在录音的时候, 不要触碰领夹麦克风, 发射器和接收器, 否则, 会有噪音产生。
- 不要将发射器靠近高电压的设备, 或者发出强电磁场的设备, 否则, 会有噪音产生。
- 请将发射器和接收器置放于干燥阴凉处。当将相机储存在一个封闭的地方时, 不要将麦克风和相机放置一起。
- 不要将发射器和接收器互换使用。

## 维护

- 不要用湿手或者脚操作。
- 请按照说明书的方式来清洁产品。
- 保护好产品防止被摔, 在安装设备时, 确保设备有安装牢靠。
- 如果设备被摔, 在使用前, 请让专业电子维修人员检查。
- 如果产品被损坏, 或者你有闻到烧焦的味道:  
立即拔掉电池, 不要自己维修, 请让专业人员维修。
- 请严格按照使用说明书来操作, 保持设备在良好的环境下使用。
- 不要擅自打开设备。

## 警告

- 将设备放置小孩触碰不到的地方。
- 不要使用漏电的电池, 不要电池投放火中。